

1 FIRST FLOOR ROOM NUMBER PLAN AREA "A"
 SCALE: 1/8" = 1'-0"

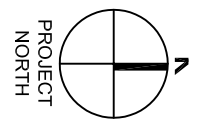
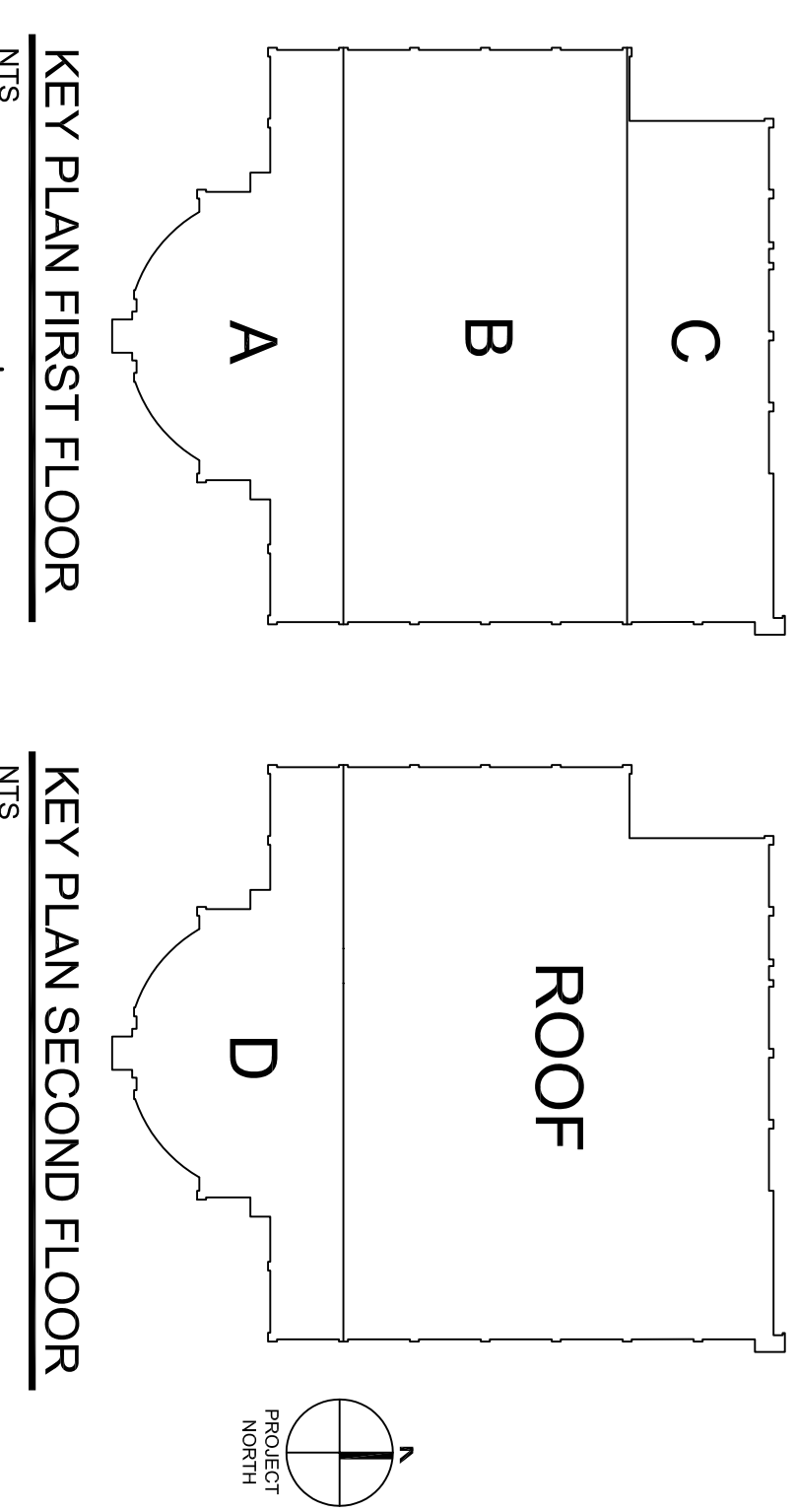
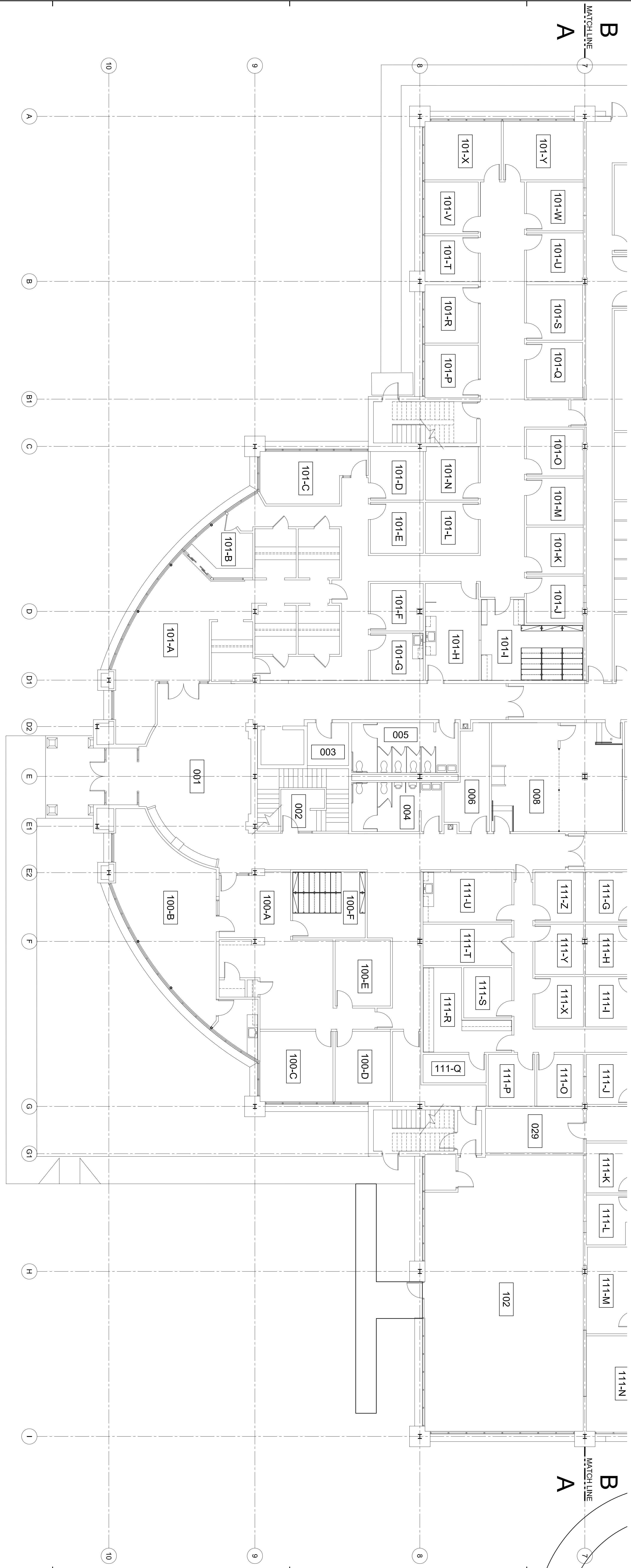

PRINT DATE: 11.1.2010
 IOTT PROJ. NO.: 09-035
 DESIGN BY: KI
 DRAWN BY: JT / KI
 SCALE: AS NOTED
 STAGE: ISSUED FOR BID
 DWG. FILE: 20090309E\IOTT\09035

TRI - COUNTY MULTI-PURPOSE CENTER
 BUILDING ENVELOPE AND
 INTERIOR RENOVATION
 SALISBURY, MARYLAND

IOTT ARCHITECTURE
 ENGINEERING
 INCORPORATED
 310 HAMMOND ST. • SUITE 100 • SALISBURY, MARYLAND
 (410) 749-7229 • FAX (410) 749-0001

I CERTIFY THAT THESE DOCUMENTS WERE PREPARED OR APPROVED BY ME A D.S. LICENSED ARCHITECT UNDER THE LAWS OF THE STATE OF MARYLAND
 KEITH IOTT LICENSE NO. 8057
 EXPIRATION DATE: 12/31/2012

REVISIONS					
NO.	DATE	REMARKS	NO.	DATE	REMARKS