

LIGHTING FIXTURES TO BE INSTALLED SHALL BE AS SHOWN ON THIS PLAN.
 LIGHTING FIXTURES TO BE REMOVED SHALL BE SHOWN WITH A CIRCLED X.
 LIGHTING FIXTURES TO BE MAINTAINED SHALL BE SHOWN WITH A CIRCLED O.
 LIGHTING FIXTURES TO BE RELOCATED SHALL BE SHOWN WITH A CIRCLED R.

① FIRST FLOOR PLAN - LIGHTING RESOLUTION ②

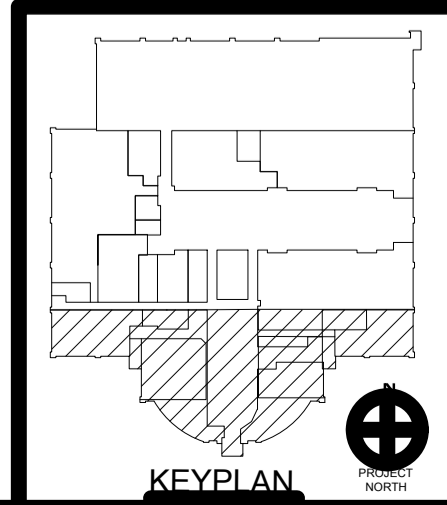
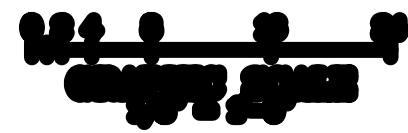

CONSULTANT: IOTT ARCHITECTURE ENGINEERING INCORPORATED 310 HANCOCK STREET SUITE 200 SALISBURY, MARYLAND 21781-2225	PROJECT: TRI-COUNTY COUNCIL REGIONAL CENTER ROUTE 50, EAST SALISBURY, MARYLAND	REVISIONS NO. DATE BY 1 11/15/00 JLM 2 11/15/00 JLM 3 11/15/00 JLM 4 11/15/00 JLM 5 11/15/00 JLM 6 11/15/00 JLM 7 11/15/00 JLM 8 11/15/00 JLM 9 11/15/00 JLM 10 11/15/00 JLM	
			SCALE: 1/8" = 1'-0" DATE: 11/15/00
PROJECT NO.: 00-0000 SHEET NO.: E-100 SHEET TITLE: FIRST FLOOR PLAN - LIGHTING RESOLUTION	IOTT ARCHITECTURE ENGINEERING INCORPORATED 310 HANCOCK STREET SUITE 200 SALISBURY, MARYLAND 21781-2225	TRI-COUNTY COUNCIL REGIONAL CENTER ROUTE 50, EAST SALISBURY, MARYLAND	REVISIONS NO. DATE BY 1 11/15/00 JLM 2 11/15/00 JLM 3 11/15/00 JLM 4 11/15/00 JLM 5 11/15/00 JLM 6 11/15/00 JLM 7 11/15/00 JLM 8 11/15/00 JLM 9 11/15/00 JLM 10 11/15/00 JLM