

1. ALL ROOMS SHALL BE PROVIDED WITH...
 2. ALL ROOMS SHALL BE PROVIDED WITH...
 3. ALL ROOMS SHALL BE PROVIDED WITH...
 4. ALL ROOMS SHALL BE PROVIDED WITH...

① SECOND FLOOR PLAN - LIGHTING RESOLUTION ②

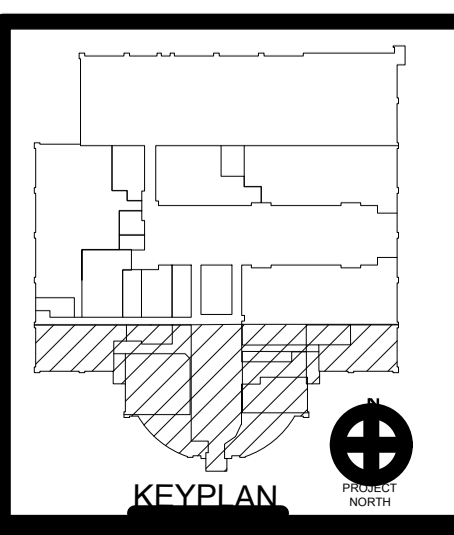
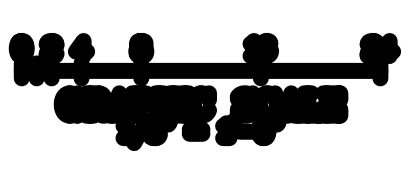

E 102	PROJECT NUMBER: 102 SHEET NUMBER: 102 DATE: 10/20/2010	REVISIONS NO. DATE BY
	TRI-COUNTY COUNCIL REGIONAL CENTER ROUTE 50, EAST SALISBURY, MARYLAND SECOND FLOOR PLAN - LIGHTING DEVELOPMENT	SCHEINER, PAIT & ASSOCIATES, INC. ARCHITECTURE ENGINEERING INCORPORATED 310 HARMONSBY SUITE 100 SALISBURY, MARYLAND 21781 TEL: 410-326-2257 FAX: 410-326-2258