

① FIRST FLOOR PLAN - LIGHTING

ALL ROOMS ARE TO BE FINISHED WITH 12" X 12" POLISHED CONCRETE
 FLOORING EXCEPT WHERE NOTED OTHERWISE
 ALL WALLS ARE TO BE FINISHED WITH 1/2" GYP BOARD
 ALL CEILING ARE TO BE FINISHED WITH 2' X 4' GYP BOARD
 ALL DOORS ARE TO BE FINISHED WITH 1 3/4" SOLID CORE
 ALL WINDOWS ARE TO BE FINISHED WITH 1/2" GYP BOARD
 ALL LIGHT FIXTURES ARE TO BE FINISHED WITH 1/2" GYP BOARD

<p> PROJECT NO. 201 SHEET NO. E-1 DATE: 10/15/2014 </p>	<p> REVISIONS NO. DATE BY 1 10/15/14 JLM 2 10/15/14 JLM 3 10/15/14 JLM 4 10/15/14 JLM 5 10/15/14 JLM 6 10/15/14 JLM 7 10/15/14 JLM 8 10/15/14 JLM 9 10/15/14 JLM 10 10/15/14 JLM 11 10/15/14 JLM 12 10/15/14 JLM 13 10/15/14 JLM 14 10/15/14 JLM 15 10/15/14 JLM 16 10/15/14 JLM 17 10/15/14 JLM 18 10/15/14 JLM 19 10/15/14 JLM 20 10/15/14 JLM 21 10/15/14 JLM 22 10/15/14 JLM 23 10/15/14 JLM 24 10/15/14 JLM 25 10/15/14 JLM 26 10/15/14 JLM 27 10/15/14 JLM 28 10/15/14 JLM 29 10/15/14 JLM 30 10/15/14 JLM 31 10/15/14 JLM 32 10/15/14 JLM 33 10/15/14 JLM 34 10/15/14 JLM 35 10/15/14 JLM 36 10/15/14 JLM 37 10/15/14 JLM 38 10/15/14 JLM 39 10/15/14 JLM 40 10/15/14 JLM 41 10/15/14 JLM 42 10/15/14 JLM 43 10/15/14 JLM 44 10/15/14 JLM 45 10/15/14 JLM 46 10/15/14 JLM 47 10/15/14 JLM 48 10/15/14 JLM 49 10/15/14 JLM 50 10/15/14 JLM 51 10/15/14 JLM 52 10/15/14 JLM 53 10/15/14 JLM 54 10/15/14 JLM 55 10/15/14 JLM 56 10/15/14 JLM 57 10/15/14 JLM 58 10/15/14 JLM 59 10/15/14 JLM 60 10/15/14 JLM 61 10/15/14 JLM 62 10/15/14 JLM 63 10/15/14 JLM 64 10/15/14 JLM 65 10/15/14 JLM 66 10/15/14 JLM 67 10/15/14 JLM 68 10/15/14 JLM 69 10/15/14 JLM 70 10/15/14 JLM 71 10/15/14 JLM 72 10/15/14 JLM 73 10/15/14 JLM 74 10/15/14 JLM 75 10/15/14 JLM 76 10/15/14 JLM 77 10/15/14 JLM 78 10/15/14 JLM 79 10/15/14 JLM 80 10/15/14 JLM 81 10/15/14 JLM 82 10/15/14 JLM 83 10/15/14 JLM 84 10/15/14 JLM 85 10/15/14 JLM 86 10/15/14 JLM 87 10/15/14 JLM 88 10/15/14 JLM 89 10/15/14 JLM 90 10/15/14 JLM 91 10/15/14 JLM 92 10/15/14 JLM 93 10/15/14 JLM 94 10/15/14 JLM 95 10/15/14 JLM 96 10/15/14 JLM 97 10/15/14 JLM 98 10/15/14 JLM 99 10/15/14 JLM 100 10/15/14 JLM </p>	<p> SCHEINBERG, P.I.T. & ASSOCIATES, INC. ARCHITECTURE ENGINEERING CONSULTING ENGINEERS 300 HANCOCK STREET SUITE 200 SALISBURY, MARYLAND 21781 TEL: 410-541-1100 FAX: 410-541-1101 WWW.SCHEINBERGPA.COM </p>	<p> LOTT ARCHITECTURE ENGINEERING INCORPORATED 300 HANCOCK STREET SUITE 200 SALISBURY, MARYLAND 21781 TEL: 410-541-1100 FAX: 410-541-1101 WWW.LOTTARCHITECTURE.COM </p>
---	--	--	---

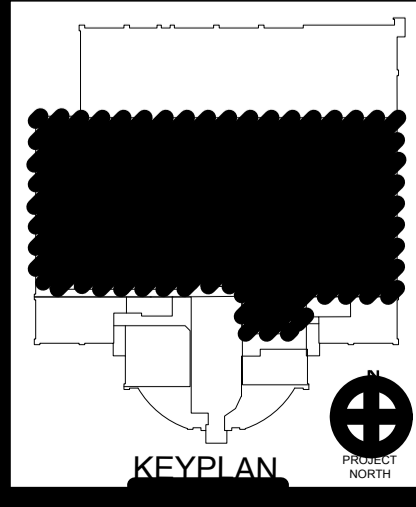

E
 201