

EXISTING MECHANICAL ROOM TO REMAIN. ALL OTHER AREAS TO BE DEMOLISHED AND RECONSTRUCTED AS SHOWN.

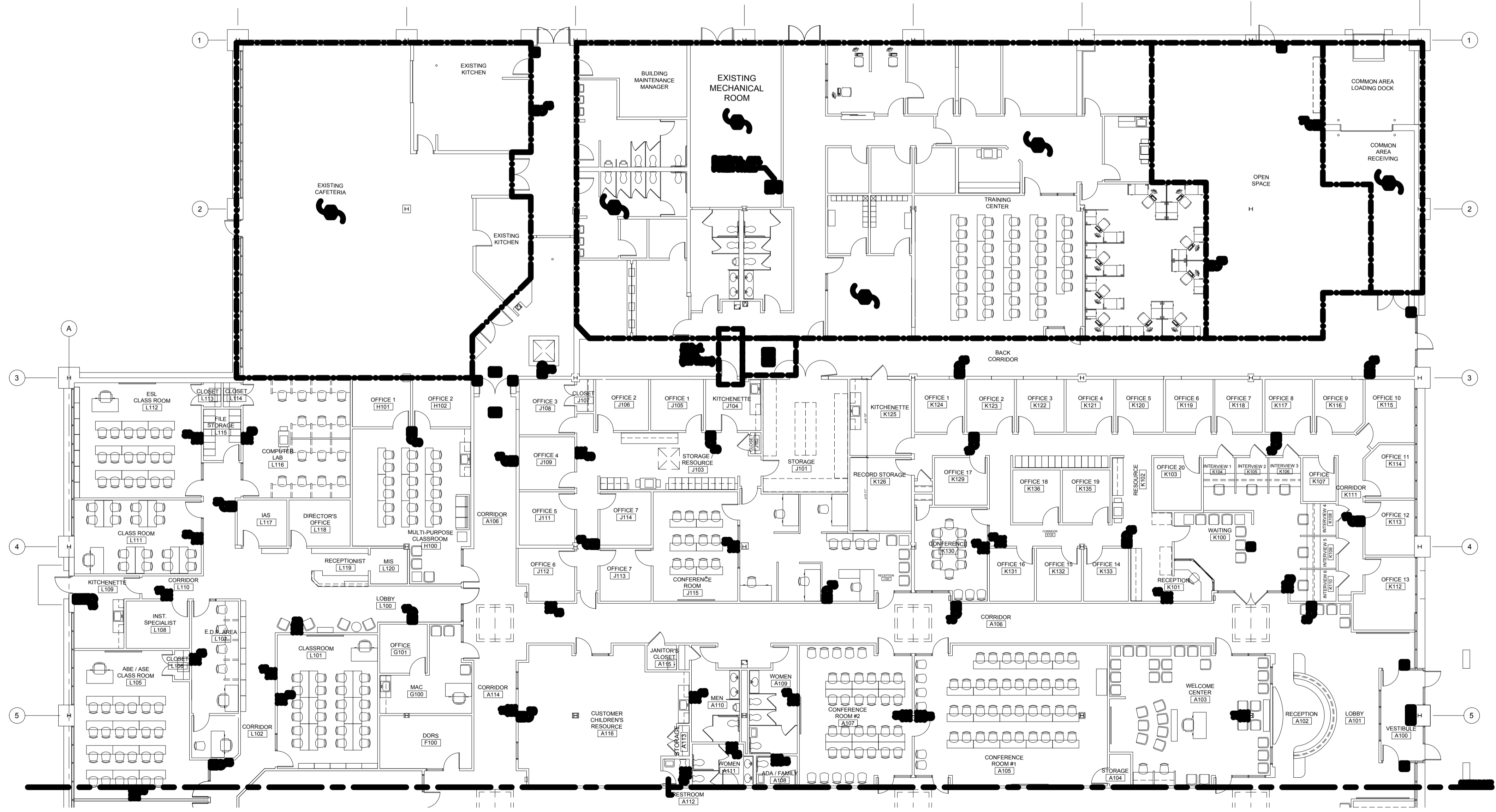

1 FIRST FLOOR PLAN - FIRE ALARM

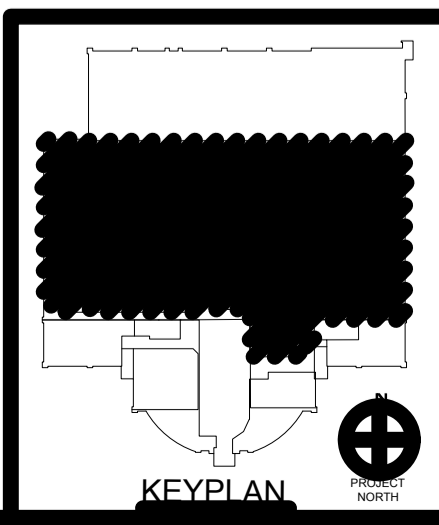
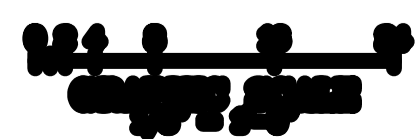

REVISIONS

| NO. | DATE | DESCRIPTION |
|-----|------|-------------|
| 1 | | |
| 2 | | |
| 3 | | |
| 4 | | |
| 5 | | |

SCHEMBERG PATE & ASSOCIATES, INC.
ARCHITECTURE
ENGINEERING
CONSULTING ENGINEERS
INCORPORATED
310 HANOVER STREET, SUITE 500, SALISBURY, MARYLAND 21801
TEL: 410.541.1000 FAX: 410.541.1001
WWW.SCHEMBERGPATE.COM

TRI-COUNTY COUNCIL
REGIONAL CENTER
ROUTE 50, EAST
SALISBURY, MARYLAND

FIRST FLOOR PLAN - FIRE ALARM

E 401

DATE: 08/20/2014